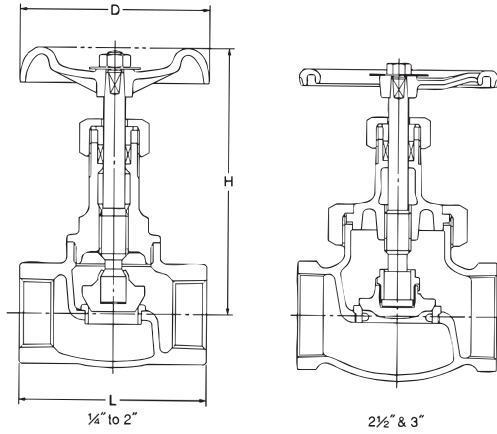

**Fig. 10SJ**



**Class JIS10K**



**Dimensions**

size	mm		mm									
	inch		8	10	15	20	25	32	40	50	65	80
L	1/4		50	55	65	80	90	105	120	140	180	200
H (OPEN)	3/8		108	108	122	125	146	160	180	198	250	280
D	1/2		60	60	70	80	90	100	115	135	180	225

120°C Static water.....1.37MPa(14kgf/cm<sup>2</sup>)  
 220°C Steam, air,gas,oil.....0.98MPa(10kgf/cm<sup>2</sup>)

● Use for lubricating or hydraulic oil is acceptable. Contact KITZ Corporation for technical advice, if valves are used as heat transfer media.

**Test pressure**

Body	2.06MPa (21kgf/cm <sup>2</sup> ) [hydrostatic]
Seat	1.51MPa (15.4kgf/cm <sup>2</sup> ) [hydrostatic]
	0.59MPa (6kgf/cm <sup>2</sup> ) [air]

**Materials**

Parts	JIS material
Body	FCD-S
Bonnet	FCD-S
Stem	SUS 420J2
Disc	SUS 403
Body seat ring	SUS 403
Gland	SUS 403 (1/2" & 3/4" : SUS420J2)
Gland packing	Non asbestos
Packing nut	FCD 400
Handwheel	FCD 450 (2 1/2" & 3" : FCD 400)
Wheel nut	SS 400
Gasket*	Non asbestos
Bonnet ring*	FCD-S
Name plate	A1050P

\* Only for 2 1/2" & 3"

**Fig. 10SJB**



**Class JIS10K**

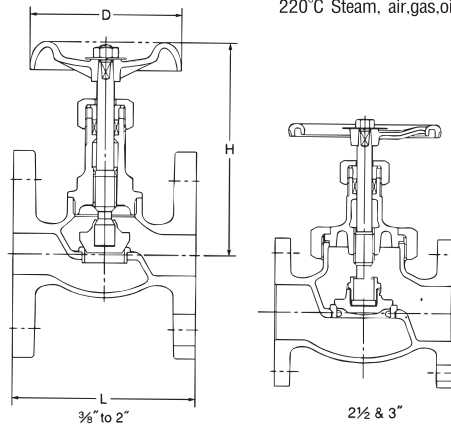

**Dimensions**

size	mm		mm								
	inch		10	15	20	25	32	40	50	65	80
L	3/8		85	85	95	110	130	150	180	210	240
H (OPEN)	1/2		108	122	125	146	160	180	198	250	280
D	3/4		60	70	80	90	100	115	135	180	225

120°C Static water.....1.37MPa(14kgf/cm<sup>2</sup>)  
 220°C Steam, air,gas,oil.....0.98MPa(10kgf/cm<sup>2</sup>)

● Use for lubricating or hydraulic oil is acceptable. Contact KITZ Corporation for technical advice, if valves are used as heat transfer media.

**Test pressure**

Body	2.06MPa (21kgf/cm <sup>2</sup> ) [hydrostatic]
Seat	1.51MPa (15.4kgf/cm <sup>2</sup> ) [hydrostatic]
	0.59MPa (6kgf/cm <sup>2</sup> ) [air]

**Materials**

Parts	JIS material
Body	FCD-S
Bonnet	FCD-S
Stem	SUS 420J2
Disc	SUS 403
Body seat ring	SUS 403
Gland	SUS 403 (1/2" & 3/4" : SUS420J2)
Gland packing	Non asbestos
Packing nut	FCD 400
Handwheel	FCD 450 (2 1/2" & 3" : FCD 400)
Wheel nut	SS 400
Gasket*	Non asbestos
Bonnet ring*	FCD-S
Name plate	A1050P

\* Only for 2 1/2" & 3"

**Fig. 10SPBOF**



**Class JIS10K**

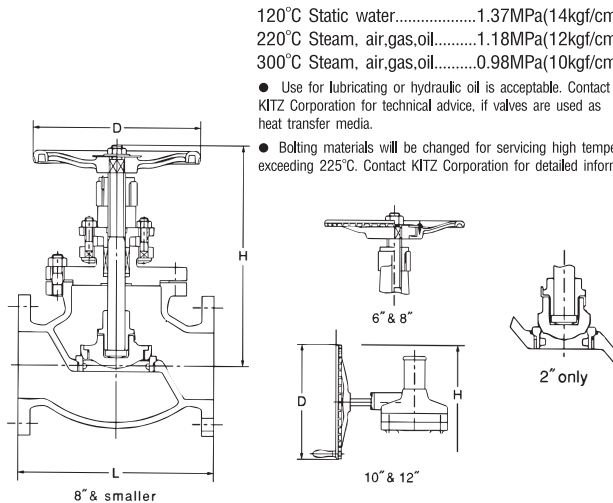

**Dimensions**

size	mm		mm								
	inch		50	65	80	100	125	150	200	250	300
L	2		203	216	241	292	356	406	495	622	698
H (OPEN)	2 1/2		302	313	356	377	460	524	585	880	943
D	3		200	225	250	250	300	350	400	360	360

120°C Static water.....1.37MPa(14kgf/cm<sup>2</sup>)  
 220°C Steam, air,gas,oil.....1.18MPa(12kgf/cm<sup>2</sup>)  
 300°C Steam, air,gas,oil.....0.98MPa(10kgf/cm<sup>2</sup>)

● Use for lubricating or hydraulic oil is acceptable. Contact KITZ Corporation for technical advice, if valves are used as heat transfer media.

● Bolting materials will be changed for servicing high temperature exceeding 225°C. Contact KITZ Corporation for detailed information.

**Test pressure**

Body	2.06MPa (21kgf/cm <sup>2</sup> ) [hydrostatic]
Seat	1.51MPa (15.4kgf/cm <sup>2</sup> ) [hydrostatic]
	0.59MPa (6kgf/cm <sup>2</sup> ) [air]

**Materials**

Parts	JIS material
Body	FCD-S
Bonnet	FCD-S
Stem	SUS 403
Disc	FCD-S (2" : SUS403)
Disc seat ring	SUS 403 (1/2"-4" : SCS1)
Body seat ring	SUS 403 (1/2"-4" : SCS1)
Lock nut	FCD-S
Gland	FCD-S
Gland packing	Non asbestos
Handwheel	FCD 400
Wheel nut	SS 400
Packing washer	SUS 403
Bonnet bolt/nut	SS 400
Gland bolt/nut	SS 400
Gasket	Non asbestos
Name plate	A1050P
Yoke bush	C6782BD

Asbestos-free gaskets are optional.

**Fig. 20SYBO**



**Class JIS20K**

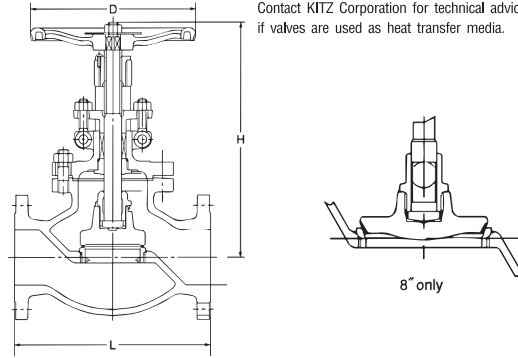

120°C Static water..... 2.75MPa(28kgf/cm<sup>2</sup>)  
 220°C Steam, air, gas, oil ..... 2.45MPa(25kgf/cm<sup>2</sup>)  
 300°C Steam, air, gas, oil ..... 2.26MPa(23kgf/cm<sup>2</sup>)  
 350°C Steam, air, gas, oil ..... 1.96MPa(20kgf/cm<sup>2</sup>)

- Use for lubricating or hydraulic oil is acceptable. Contact KITZ Corporation for technical advice, if valves are used as heat transfer media.

**Test pressure**

Body	4.12MPa (42kgf/cm <sup>2</sup> ) [hydrostatic]
Seat	3.02MPa (30.8kgf/cm <sup>2</sup> ) [hydrostatic] 0.59MPa (6kgf/cm <sup>2</sup> ) [air]

**Materials**

Parts	JIS material
Body	FCD-S
Bonnet	FCD-S
Stem	SUS 403
Disc	SFVC2A+HF*
Lock nut	FCD-S
Body seat ring	SFVC2A+HF*
Gland	FCD-S
Gland packing	Non asbestos
Handwheel	FCD 400
Wheel nut	SS 400
Bonnet bolt/nut	S45C
Gland bolt/nut	SS 400
Yoke bush	C6782BE
Gasket	Non asbestos
Name plate	A1050P

\*Hard-faced with Co-Cr-W alloy

**Dimensions**

size	mm	50	65	80	100	125	150	200
	inch	2	2½	3	4	5	6	8
L		267	292	318	356	400	444	559
H (OPEN)		243	347	382	457	534	593	697
D		225	250	250	300	350	400	560

**Fig. 20SY**



**Class JIS20K**

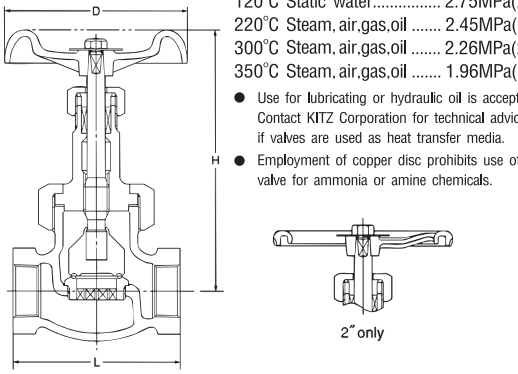

120°C Static water..... 2.75MPa(28kgf/cm<sup>2</sup>)  
 220°C Steam, air, gas, oil ..... 2.45MPa(25kgf/cm<sup>2</sup>)  
 300°C Steam, air, gas, oil ..... 2.26MPa(23kgf/cm<sup>2</sup>)  
 350°C Steam, air, gas, oil ..... 1.96MPa(20kgf/cm<sup>2</sup>)

- Use for lubricating or hydraulic oil is acceptable. Contact KITZ Corporation for technical advice, if valves are used as heat transfer media.
- Employment of copper disc prohibits use of this valve for ammonia or amine chemicals.

**Test pressure**

Body	4.12MPa (42kgf/cm <sup>2</sup> ) [hydrostatic]
Seat	3.02MPa (30.8kgf/cm <sup>2</sup> ) [hydrostatic] 0.59MPa (6kgf/cm <sup>2</sup> ) [air]

**Materials**

Parts	JIS material
Body	FCD-S
Bonnet	FCD-S
Stem	SUS 420J2
Disc	SUS 403+HF*
Body seat ring	SCS13A+HF*
Gland	SUS 403 (3/8" & 1/2" : SUS420J2)
Gland packing	Non asbestos
Packing nut	FCD 400
Handwheel	FCD 450 (2" : FCD 400)
Wheel nut	SS 400
Bonnet ring	FCD-S
Gasket	C1100P-0
Name plate	A1050P

\*Hard-faced with Co-Cr-W alloy

**Dimensions**

size	mm	10	15	20	25	32	40	50
	inch	3/8	1/2	3/4	1	1¼	1½	2
L		75	78	91	105	122	135	160
H (OPEN)		136	138	157	178	202	210	239
D		70	80	100	115	135	135	180

**Fig. 20SYB**



**Class JIS20K**

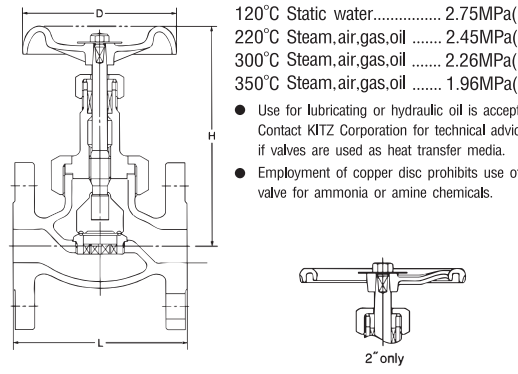

120°C Static water..... 2.75MPa(28kgf/cm<sup>2</sup>)  
 220°C Steam, air, gas, oil ..... 2.45MPa(25kgf/cm<sup>2</sup>)  
 300°C Steam, air, gas, oil ..... 2.26MPa(23kgf/cm<sup>2</sup>)  
 350°C Steam, air, gas, oil ..... 1.96MPa(20kgf/cm<sup>2</sup>)

- Use for lubricating or hydraulic oil is acceptable. Contact KITZ Corporation for technical advice, if valves are used as heat transfer media.
- Employment of copper disc prohibits use of this valve for ammonia or amine chemicals.

**Test pressure**

Body	4.12MPa (42kgf/cm <sup>2</sup> ) [hydrostatic]
Seat	3.02MPa (30.8kgf/cm <sup>2</sup> ) [hydrostatic] 0.59MPa (6kgf/cm <sup>2</sup> ) [air]

**Materials**

Parts	JIS material
Body	FCD-S
Bonnet	FCD-S
Stem	SUS 420J2
Disc	SUS 403+HF*
Body seat ring	SCS13A+HF*
Gland	SUS 403 (3/8" & 1/2" : SUS420J2)
Gland packing	Non asbestos
Packing nut	FCD 400
Handwheel	FCD 450 (2" : FCD 400)
Wheel nut	SS 400
Gasket	C1100P-0
Name plate	A1050P

\*Hard-faced with Co-Cr-W alloy

**Dimensions**

size	mm	10	15	20	25	32	40	50
	inch	3/8	1/2	3/4	1	1¼	1½	2
L		110	110	120	130	160	180	230
H (OPEN)		136	138	157	178	202	210	239
D		70	80	100	115	135	135	180